

V90

Oil Inject Screw Compressor



PROFILE: Planned to offer maximum performance, efficiency and duration. It guarantees high airflow with a minimum energy consumption and best performances are therefore guaranteed, even in extreme conditions.

BEARINGS: Radial and thrust bearings are created to be lasting. Only first quality bearings are used.

FRONTAL SEALINGS: No oil loss thanks to excellent materials and suitable dimension. Accessibility for a simple and fast replacement.

APPLICATION: For belt and direct connection.

ASSEMBLY: Body parts are joined with O-rings, so the maintenance is easy, fast and reliable. No glues used to join parts.

ROTORS ADJUSTMENT: Threaded rings are used to adjust rotors for maintenance phases very fast, reliable and repeatables.

TECHNICAL DATA

Size	V90	
Drive	Direct by coupling or belt	
Rotor dimensions		
Outside male Diameter:	mm	89,4
Outside female Diameter:	mm	71,2
L/D:		1,55
Air Capacity (ISO 1217 ANNEX B 1996)	m³/min	0,76-3,83
Max. Working Pressure	bar g	13
Min. Working Pressure	bar g	5
Oil injected Quantity	l/min	29-40
Max Input Power	kW	22
Max main rotor Speed	rpm	8100
Max outlet air/oil Temperature	°C	105
Weight	kg	25,5

Air flow rate related to suction condition according to ISO 1217 annex C 1996:
relative humidity: 60%; suction press. (abs.): 1 bar; suction temp.: 20°C; disch. temp.: 80°C

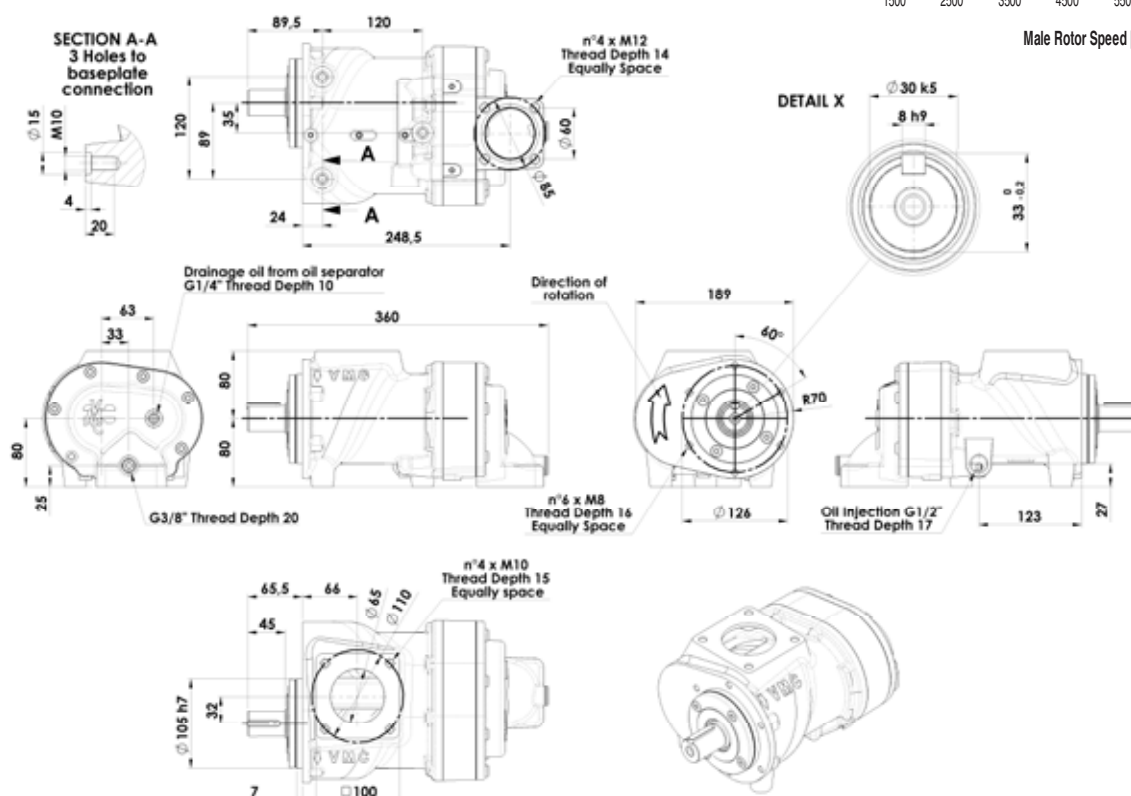
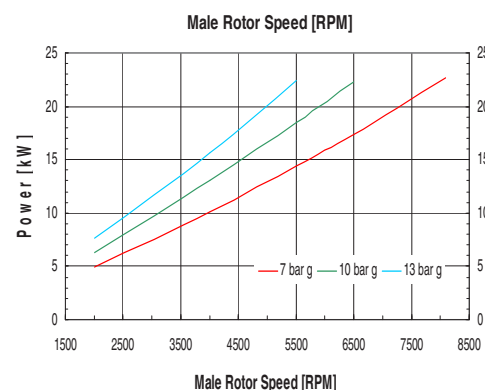
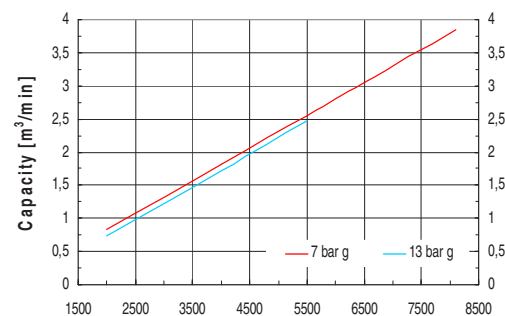



Integrated system VTDM directly connected to the air-end V series. Offer a unique system compact, extremely accessible and fast to assembly as well absolutely simply to handle. The air outlet and oil inlet have been designed for simply and fast connections. Pipe's length have been designed to be short to increase the performance and reduce the pressure drop. The inner component's position have been designed for easy, fast and secure maintenance operations. Even though compact the system offers elevated interchangeability.

TECHNICAL DATA

Size	V90/VTDM	
Air Flow Rate	m ³ /1'	see diagram of V90
Working Pressure	Bar	see diagram of V90
Oil injected quantity	Lt/1'	max 29 - 40
Oil Inlet/Outlet	Inch	3/4 Gas
Air Outlet (From Air-end)	Inch	1"1/2 Gas
Air Inlet (From Tank)	Inch	1"1/4 Gas
Air Outlet (From MPV)	Inch	1"1/4 Gas
Oil nipples Size		3/4 16 UNF
		3/4 Gas
		1-12 UNF
Air nipples Size		M 24x1,5
		M 32x1,5
		M 39x1,5
Thermostat Temp. Setting	°C	Three thermostat available: 55-70; 71-85 or 83-95
Materials	Unit's housing made in aluminium alloy anodized. Internal parts in brass, stainless steel and viton sealings	
A	mm	115
A1	mm	248
B	mm	191
C1	mm	322
Y	mm	400
Weight	Kg	29

